

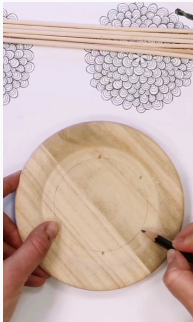

Introduction for building: Feeding-box for wild birds

You need the following materials:

- | | | |
|------------------------|-----------------------------|-----------------------------|
| • Glue Gun | • Pencil | • 6x Bamboo sticks Ø 4mm |
| • Glue Sticks | • Ruler | • 6x Wooden Olives; 14x21mm |
| • Flat-nose pliers | • Brush | • Wooden box Ø 8cm |
| • Scissors | • Acrylic color | • Wooden coaster Ø 8cm |
| • Cordless screwdriver | • 2x Wooden plates Ø 14.5cm | • Sisal twine |



First, draw around the coaster a line on the wooden plate. Mark on this line six opposite points. They should have the same distance to each other.



Now, you take the Cordless Screwdriver and drill carefully a pit on the marked points. Attention: Be careful, so that you don't drill through the points, just drill a light pit.

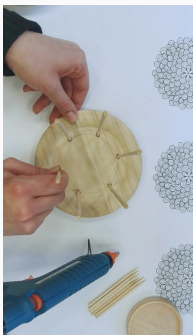

Use the flat-nose pliers to cut the bamboo sticks onto the desired length. We have cut them to 15cm. Fill drop hot glue into each drilled pit and press the bamboo sticks into them.



Now draw again six points, this time on the second plate. However, the points should be drawing on the edge of the plate. The wooden olives should now glue to the points with hot glue, so that you can use this plate as a lid.



Draw three points on the outer edge of both plates and drill a hole through all points. Make sure that the holes have the same distance apart on both plates.



If you like, you can paint the house and/or the wooden box with acrylic color. Please make sure, that the color is not harmful for the birds. We have painted only the wooden box and have left the rest unpainted.



Cut from the sisal twine three equal parts from with 1m length. Put the ends of one twine on top of each other, pull it through a drilled hole of the plate with the sticks and knot them. Now pull this double cord from bottom to top through the hole on the "lid" plate. Repeat this with the other two twines.



Finally you put the wooden box in your feeder and put the lid on it. Now pull all three twines through the hole of the lid and hang up the feeder-box.

Have fun building the feeder-box!